

DIN 471

Кольцо стопорное для вала

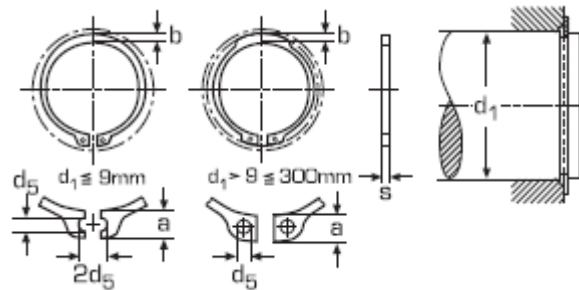

Стандарт DIN 471 соответствует ГОСТ 13942.

Материалы:

Нержавеющая сталь: А2

Сталь: сталь пружинная

d_1	a макс.	b	d_5 мин.	s
4	2.2	0.9	1	0.4
5	2.5	1.1	1	0.6
6	2.7	1.3	1.2	0.7
7	3.1	1.4	1.2	0.8
8	3.2	1.5	1.2	0.8
9	3.3	1.7	1.2	1
10	3.3	1.8	1.5	1
11	3.3	1.8	1.5	1
12	3.3	1.8	1.7	1
13	3.4	2	1.7	1
14	3.5	2.1	1.7	1
15	3.6	2.2	1.7	1
16	3.7	2.2	1.7	1
17	3.8	2.3	1.7	1
18	3.9	2.4	2	1.2
19	3.9	2.5	2	1.2
20	4	2.6	2	1.2
22	4.2	2.8	2	1.2
23	4.3	2.9	2	1.2
24	4.4	3	2	1.2
25	4.4	3	2	1.2
26	4.5	3.1	2	1.2
27	4.6	3.1	2	1.2
28	4.7	3.2	2	1.5
29	4.8	3.4	2	1.5
30	5	3.5	2	1.5

32	5.2	3.6	2.5	1.5
34	5.4	3.8	2.5	1.5
35	5.6	3.9	2.5	1.5
36	5.6	4	2.5	1.75
38	5.8	4.2	2.5	1.75
39	5.9	4.3	2.5	1.75
40	6	4.4	2.5	1.75
42	6.5	4.5	2.5	1.75
45	6.7	4.7	2.5	1.75
48	6.9	5	2.5	1.75
50	6.9	5.1	2.5	2
52	7	5.2	2.5	2
55	7.2	5.4	2.5	2
60	7.4	5.8	2.5	2
65	7.8	6.3	3	2.5
68	8	6.5	3	2.5
70	8.1	6.6	3	2.5
75	8.4	7	3	2.5
80	8.6	7.4	3	2.5
85	8.7	7.8	3.5	3
90	8.8	8.2	3.5	3
95	9.4	8.6	3.5	3
100	9.6	9	3.5	3
110	10.1	9.6	3.5	4
120	11	10.2	3.5	4
130	11.6	10.7	4	4
140	12	11.2	4	4
d₁	a макс.	b	d₅ мин.	s